

APOLLO DESIGN 05

Apollo Design 5 is inspiring by its superb use of space. The three bedrooms are each appointed with built-ins and are located together on the left side of the house. The flowing living and kitchen areas are towards the rear with seamless connections to the large outdoor living space.

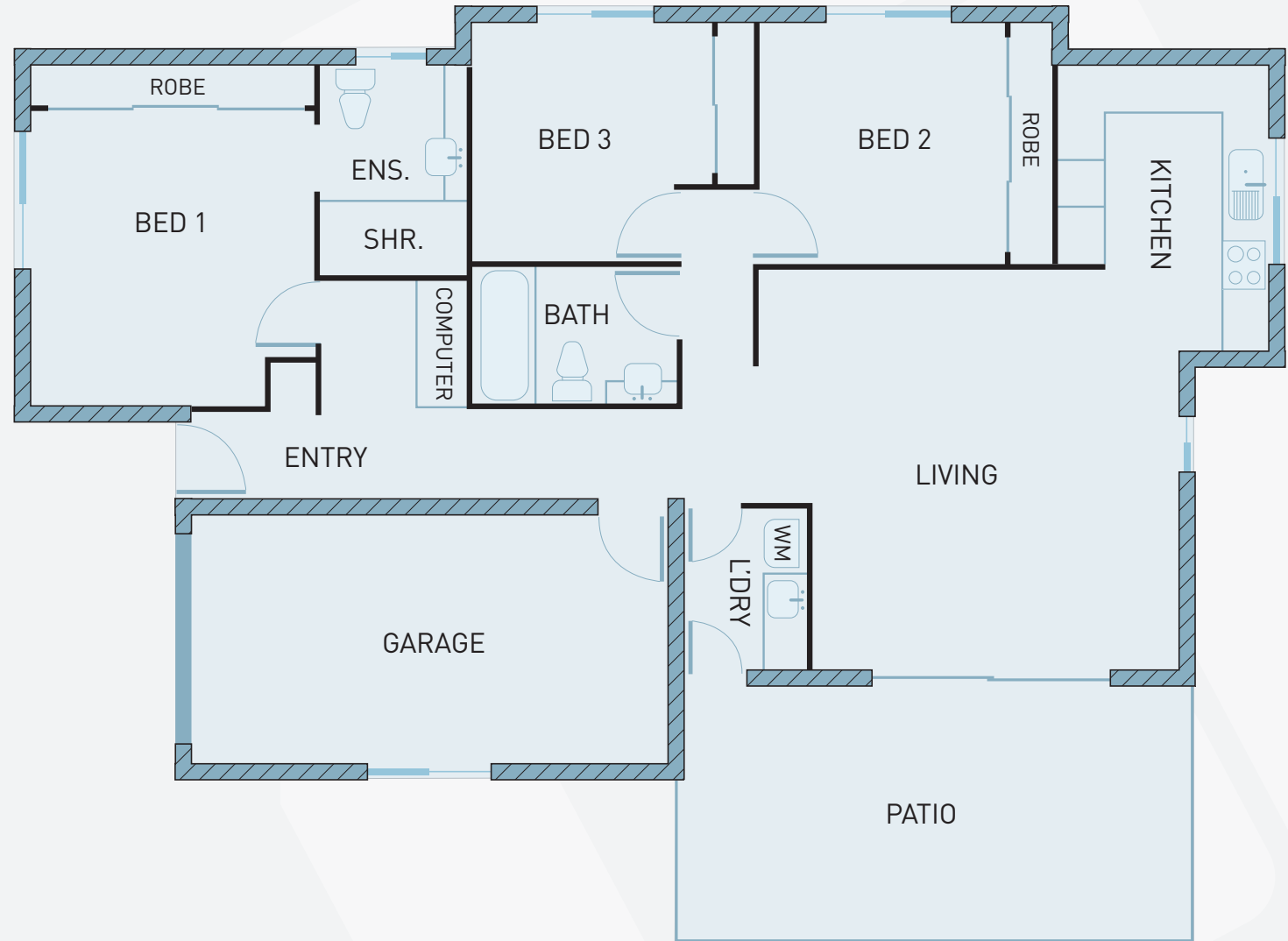

FOR UP TO DATE INFORMATION ON THIS DESIGN AND OTHERS, VISIT WWW.APOLLOCMS.COM.AU

HOUSE DETAILS



OVERALL DIMENSIONS

Area: 148m²
Squares: 16 squares
Lot: 15m wide

AREA DIMENSIONS

Bedroom 1: 10.1m ²	Living Area: 16.7m ²
Bedroom 2: 7.4m ²	Kitchen: 5.7m ²
Bedroom 3: 6.6m ²	Laundry: 2.1m ²
Bathroom: 3m ²	Patio: 14.1m ²
Ensuite: 3.2m ²	Garage: 12.9m ²

DISCLAIMER: While every reasonable care has been taken in the preparation of this brochure and all particulars contained herein are believed to be correct at the time of printing, interested parties must rely upon their own inspections and inquiries. These inserts do not and will not form any part of the contract of sale. Illustrations and photography are for presentational purposes and should be used for indicative purposes only. Furniture not included.



APOLLO CMS
CONSTRUCTION
AND MAINTENANCE
SOLUTIONS